

STATO DI PROGETTO
PLANIMETRIA AREA CORTILIVA scala 1:100

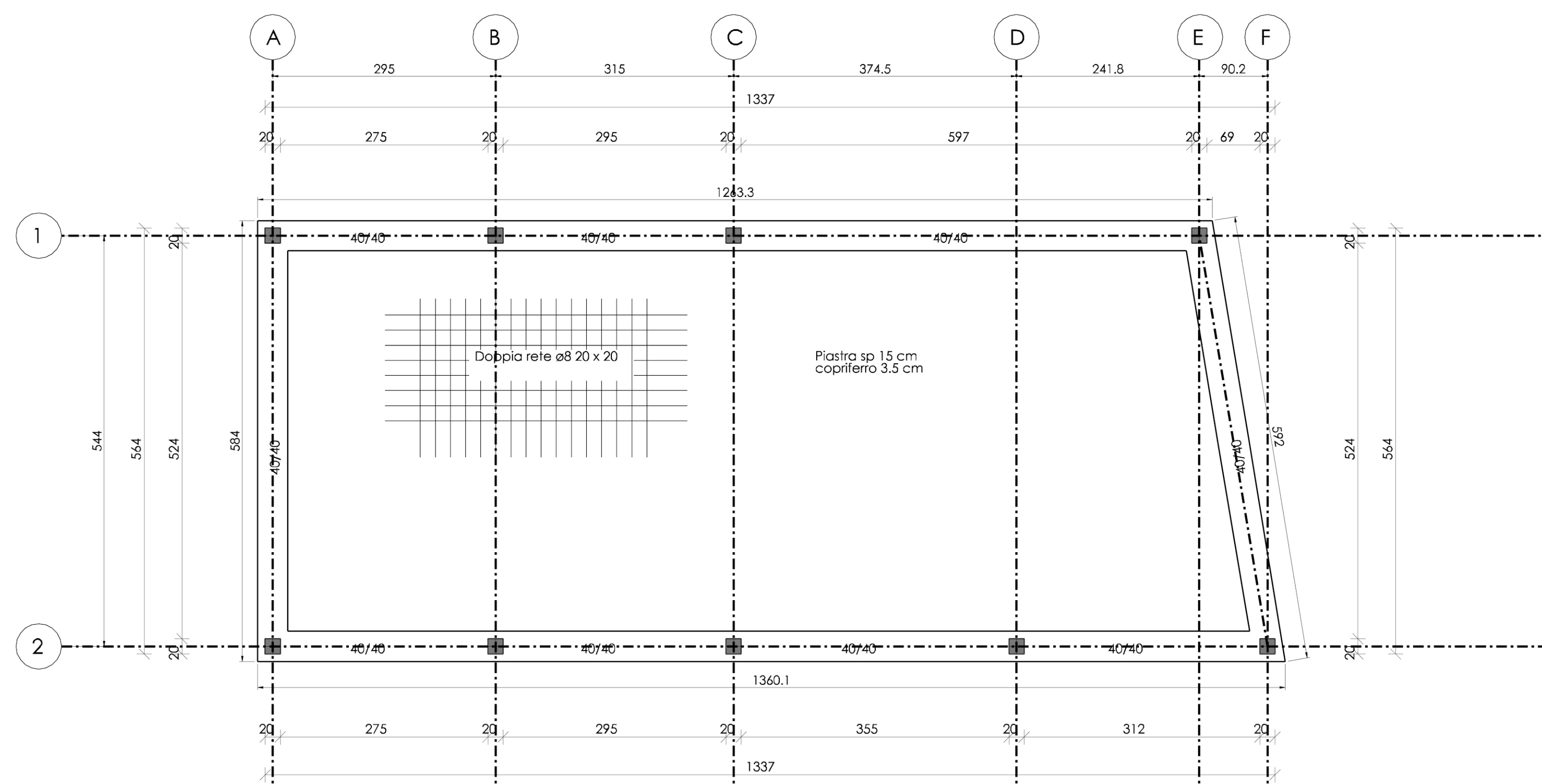

PIANTA FONDAZIONI QUOTA m: 0.00

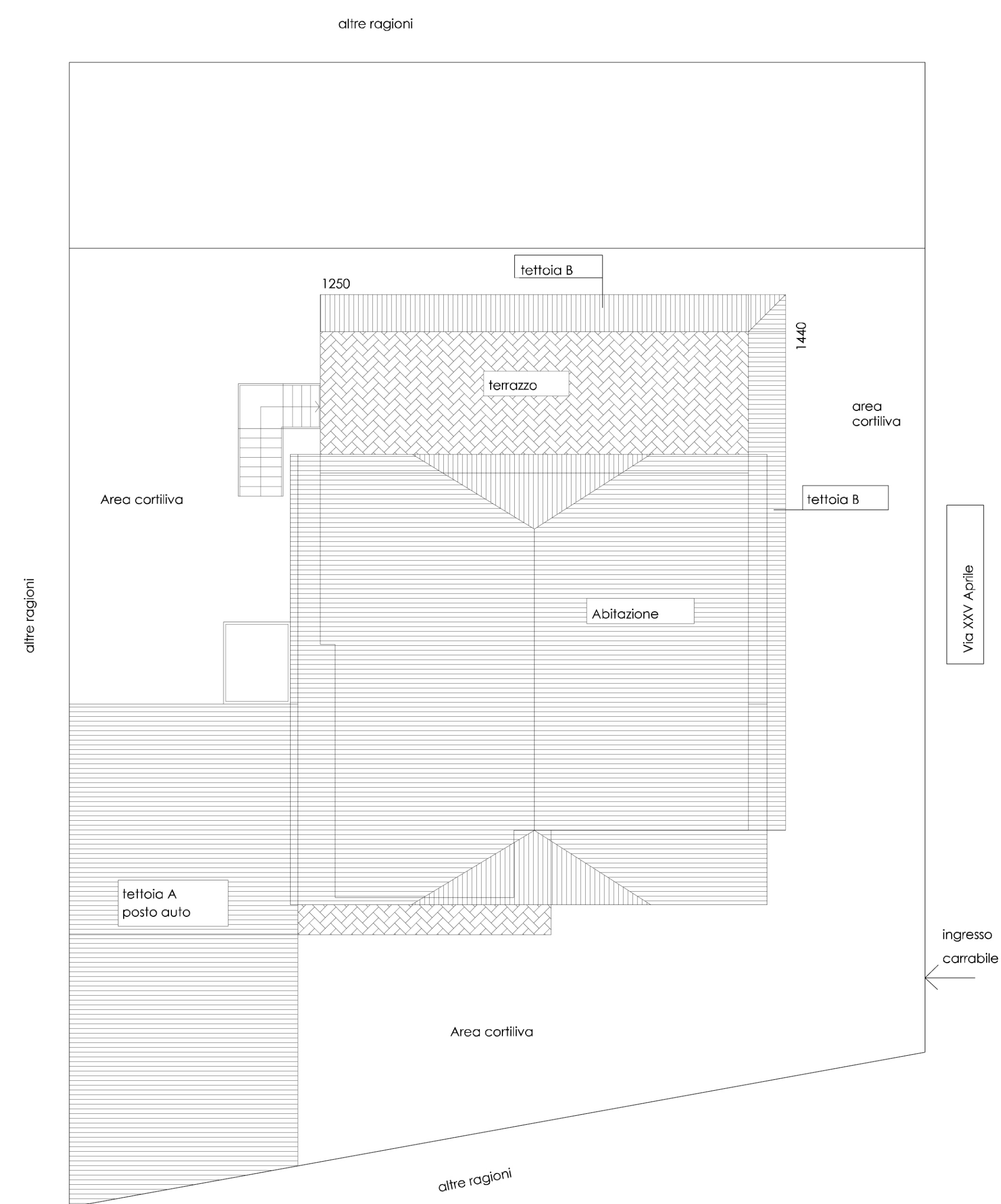
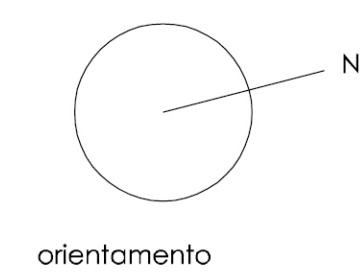
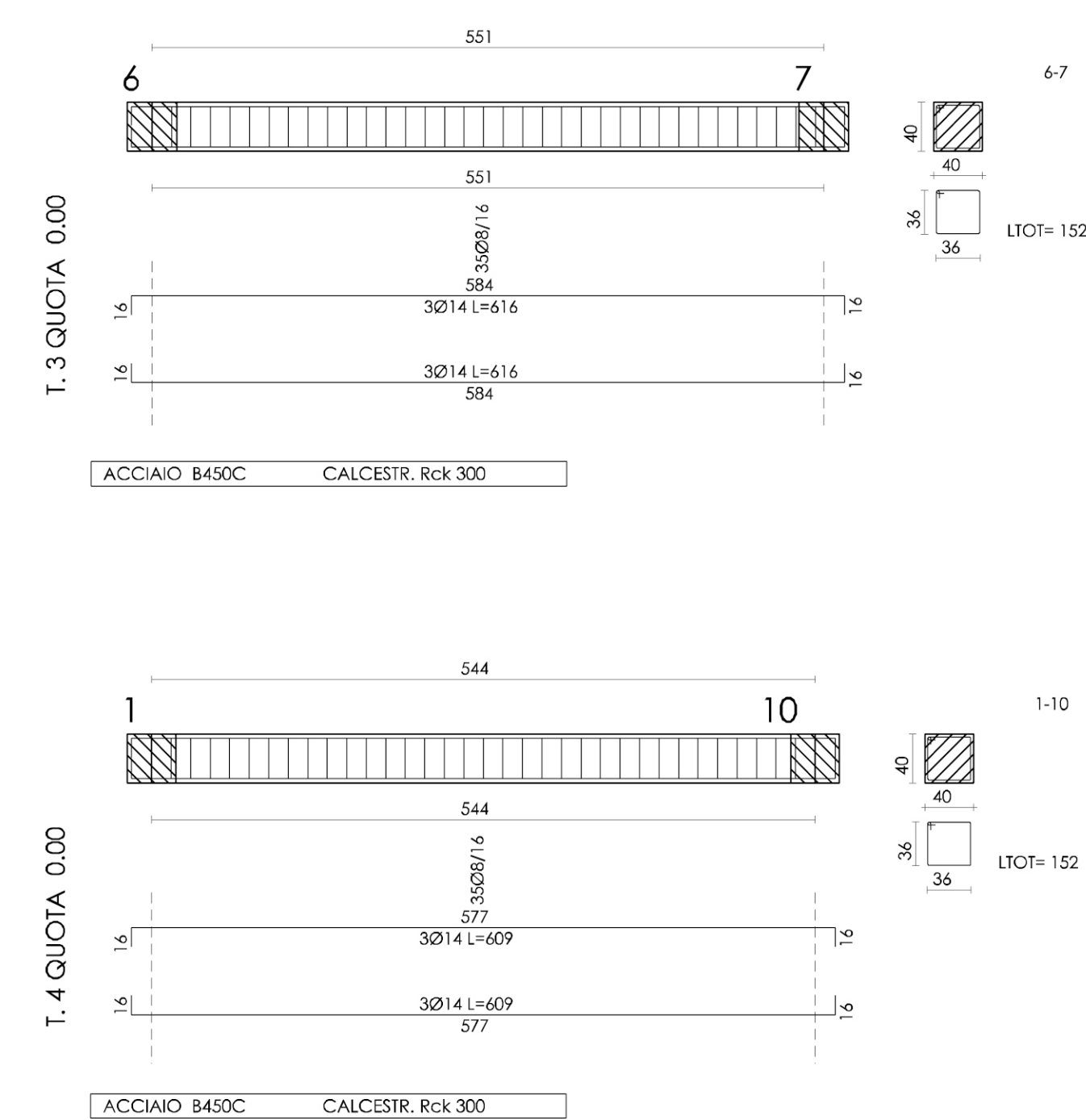
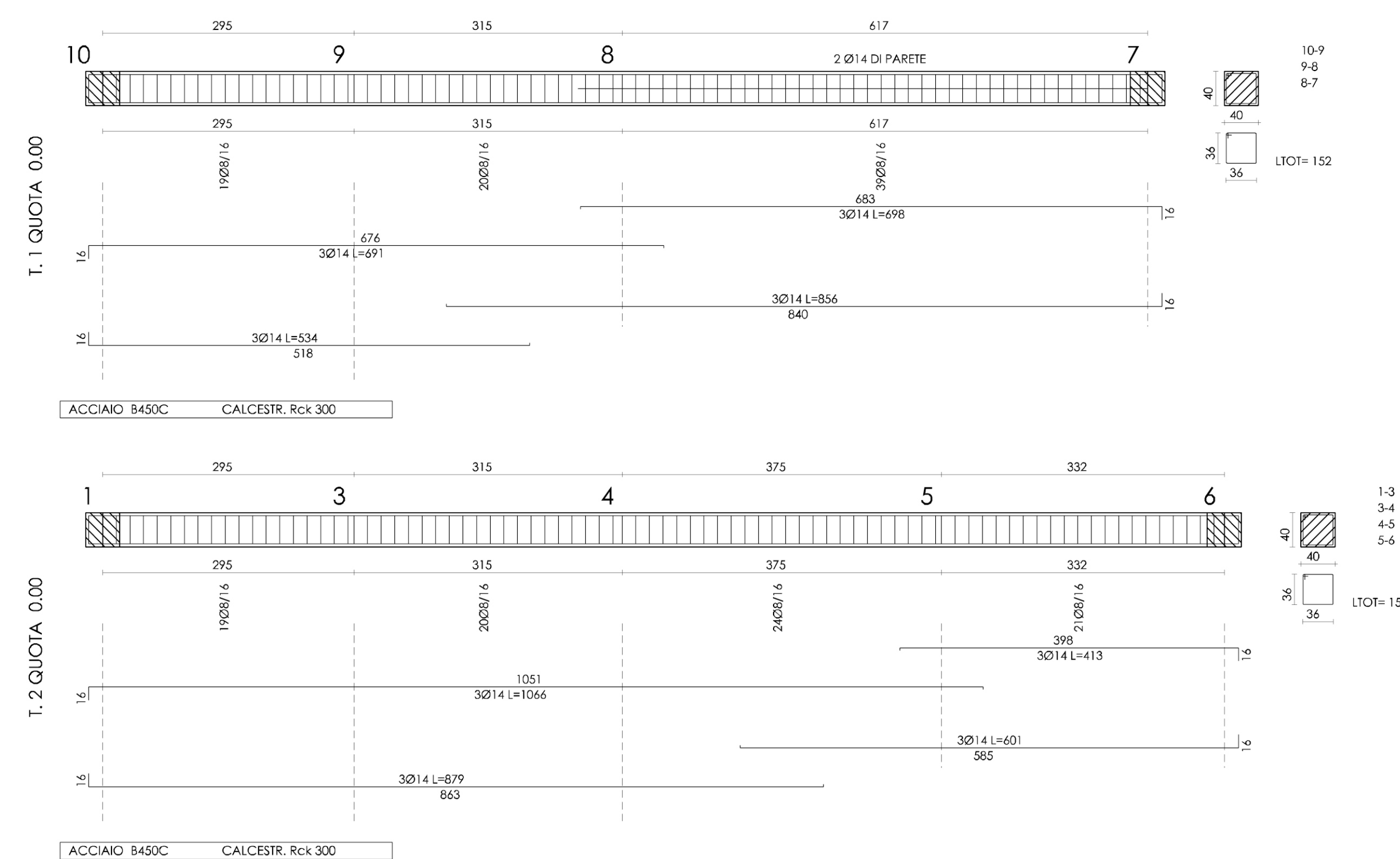

PIANTA ELEVAZIONI PILASTRI QUOTA m: 0.00

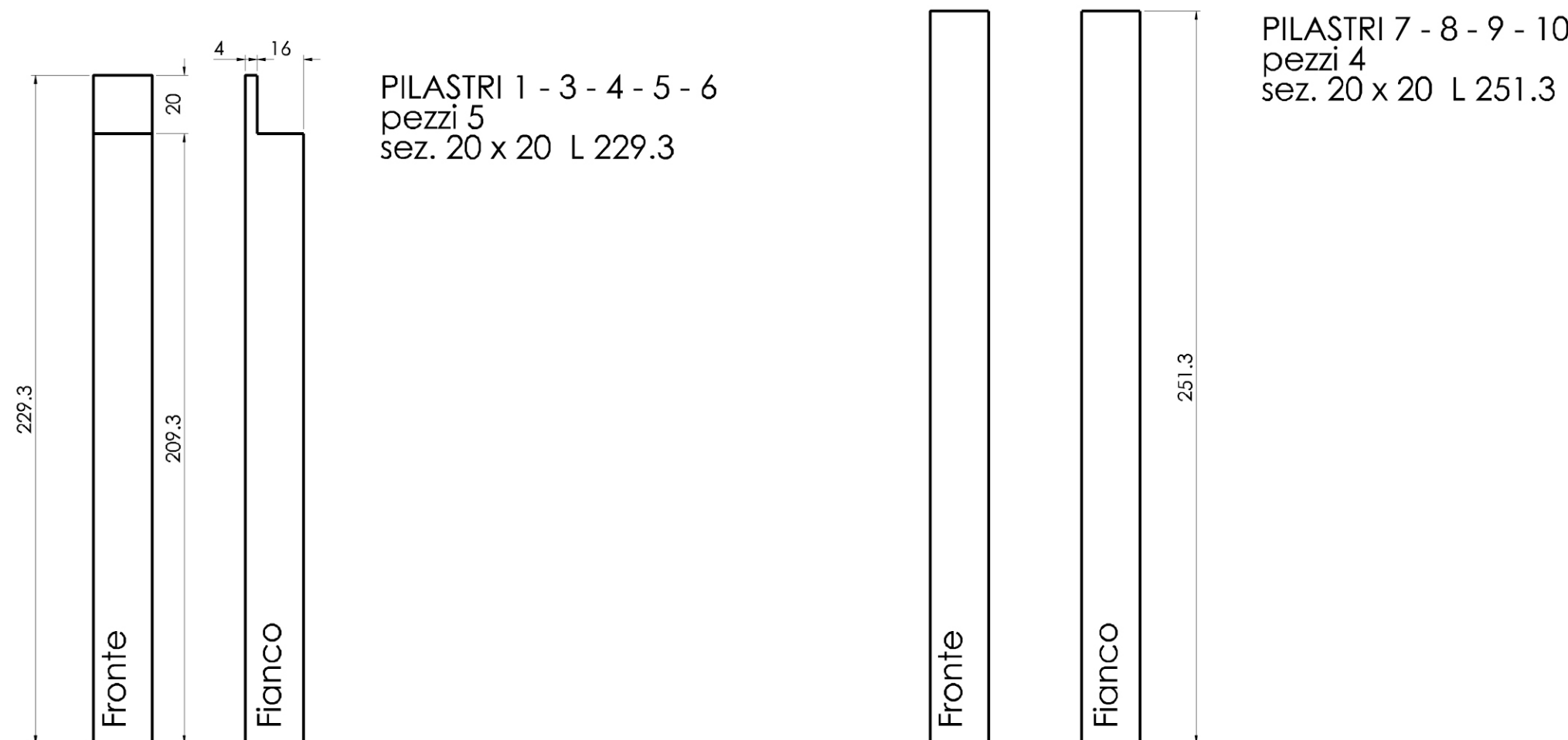
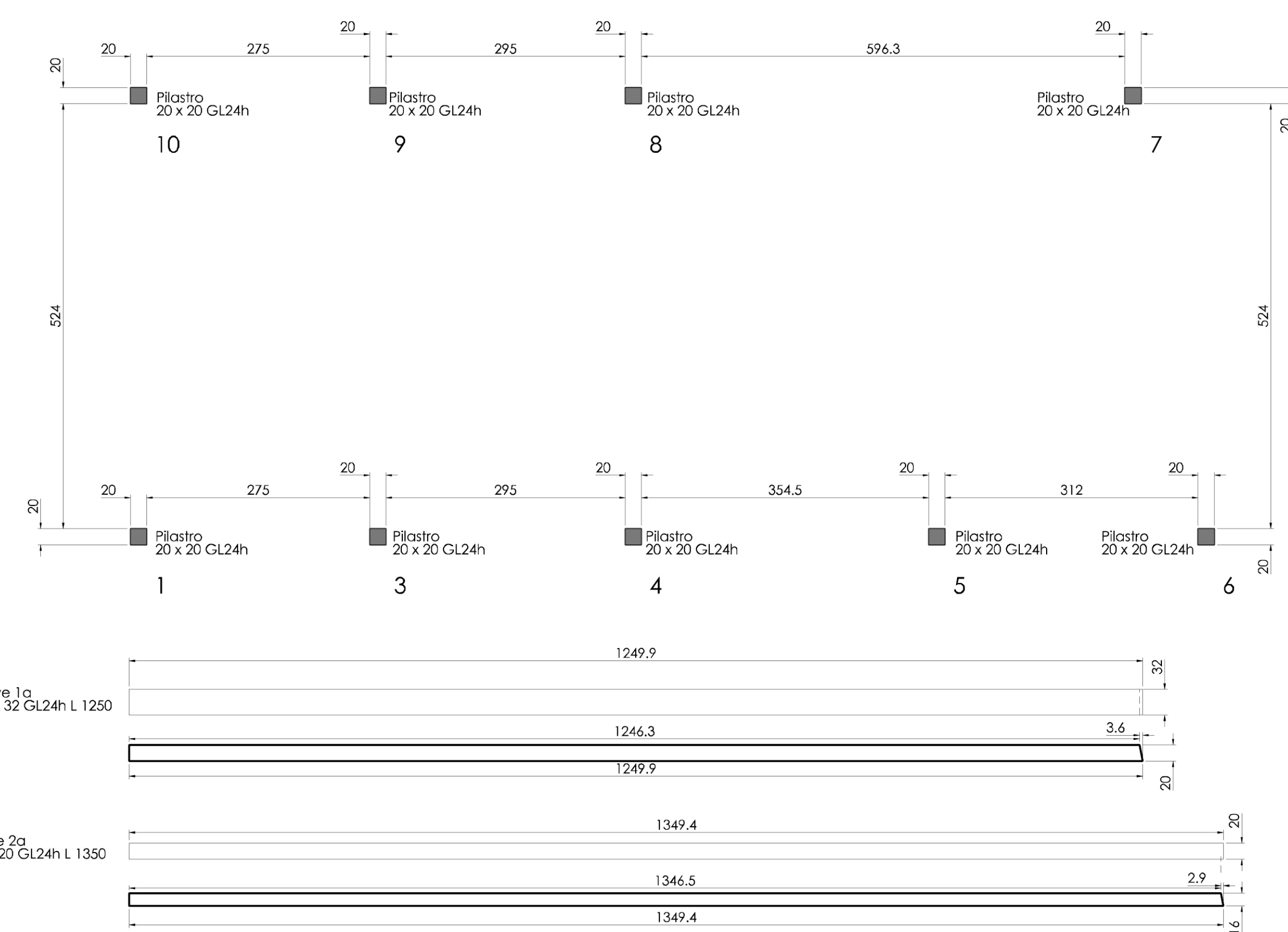

PIANTA ORDITURA PRINCIPALE QUOTA m: 2.50

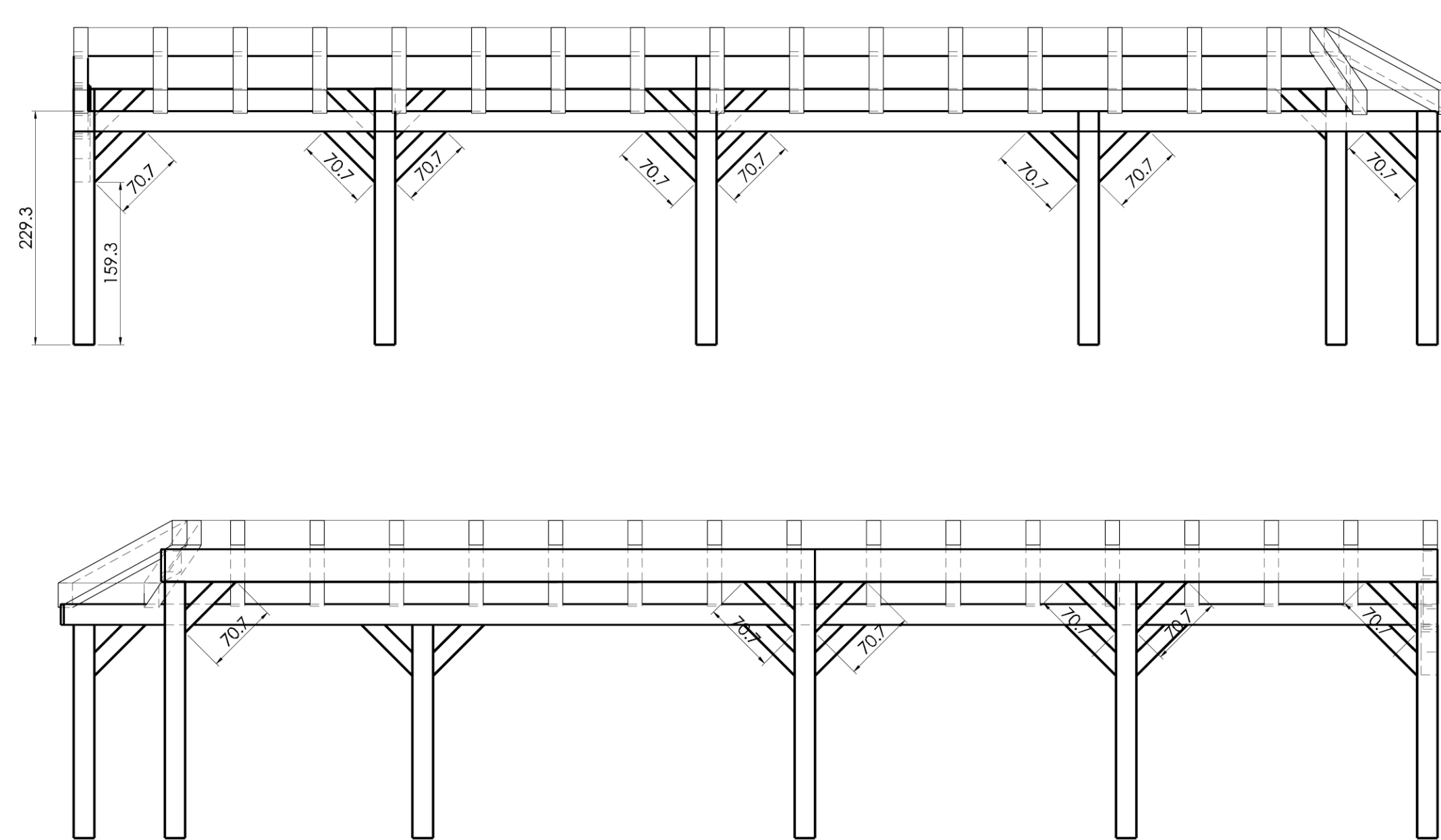
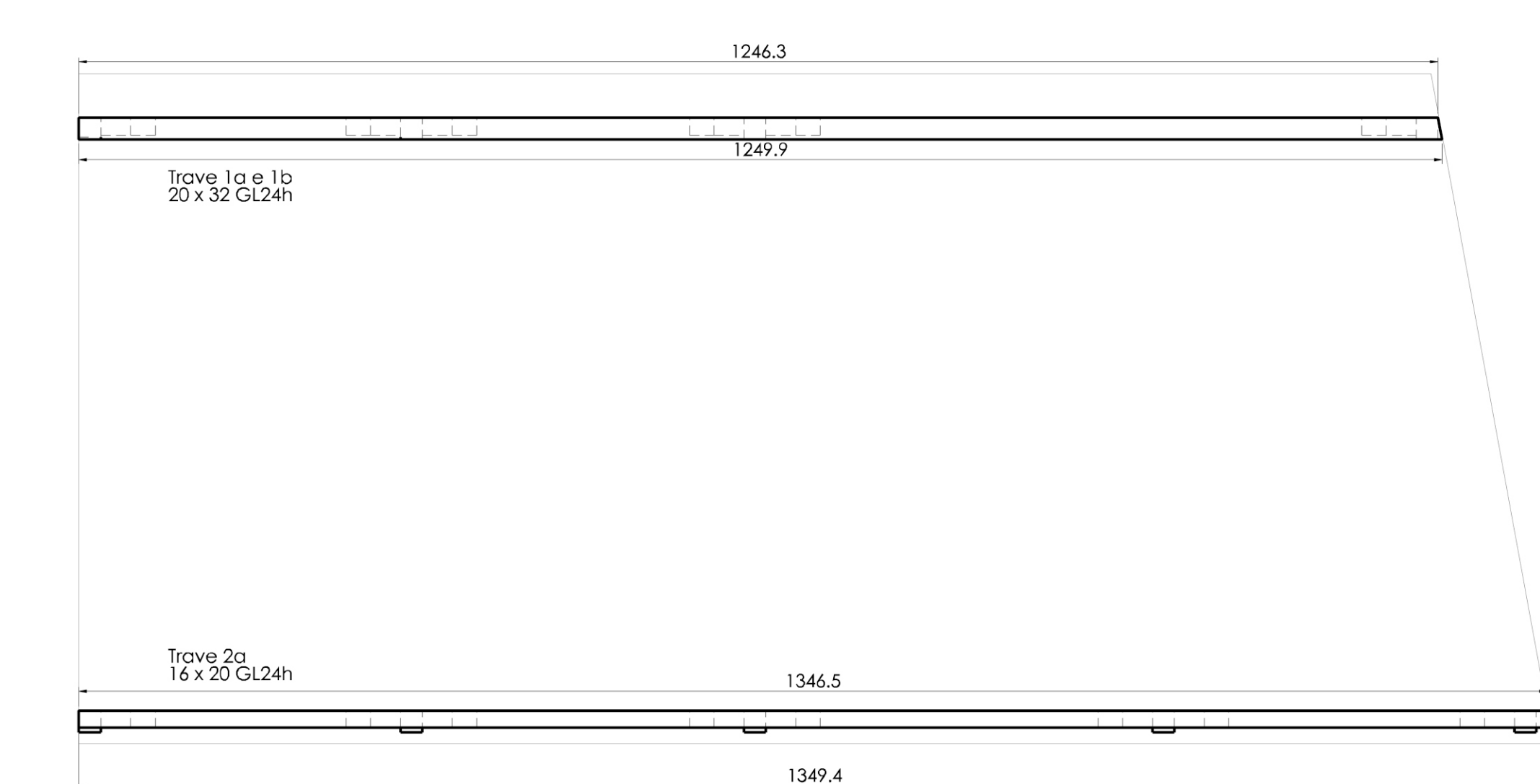

PIANTA ORDITURA SECONDARIA Quota 2.50

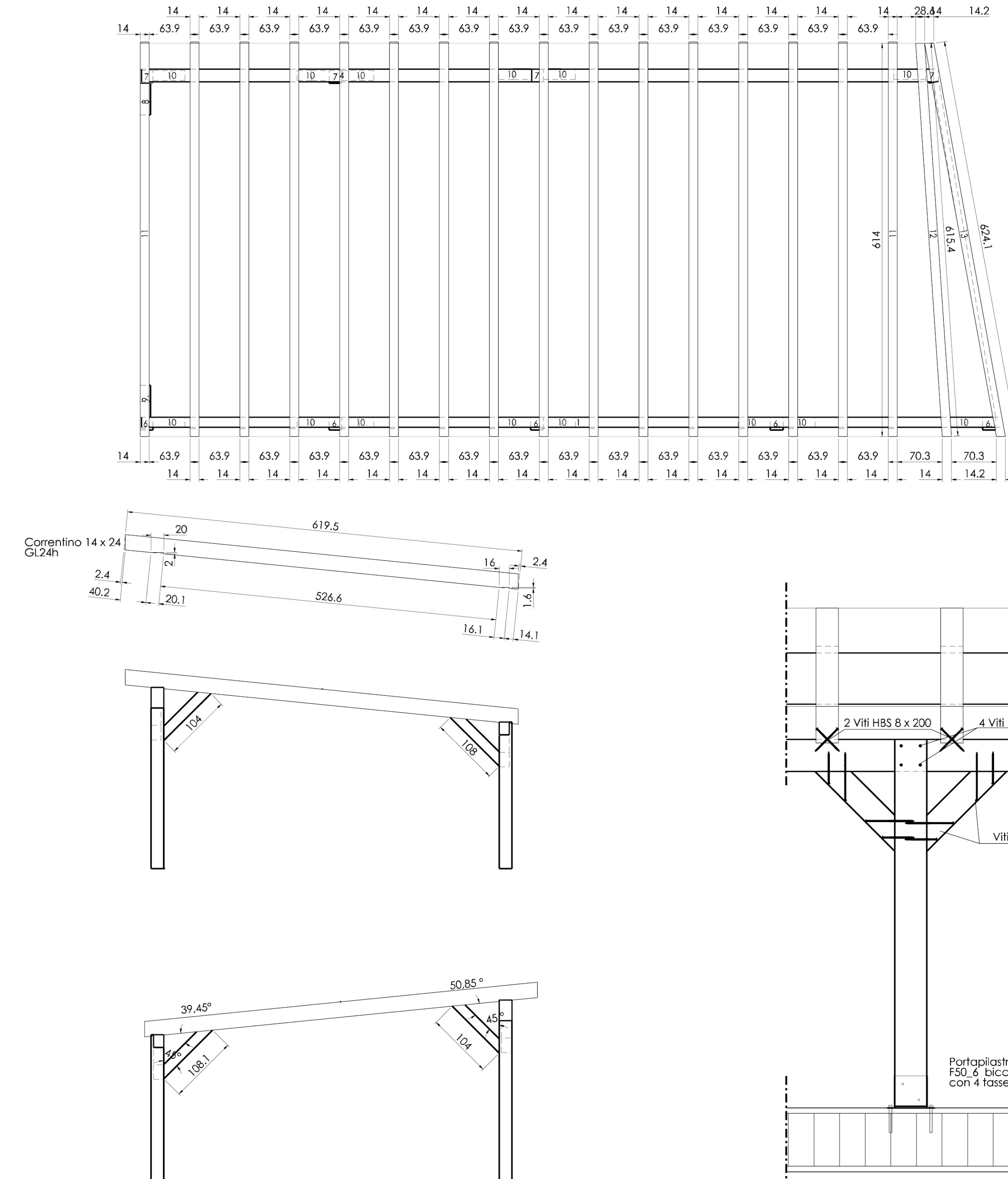

PRESCRIZIONI:

LEGENDA MISURE :

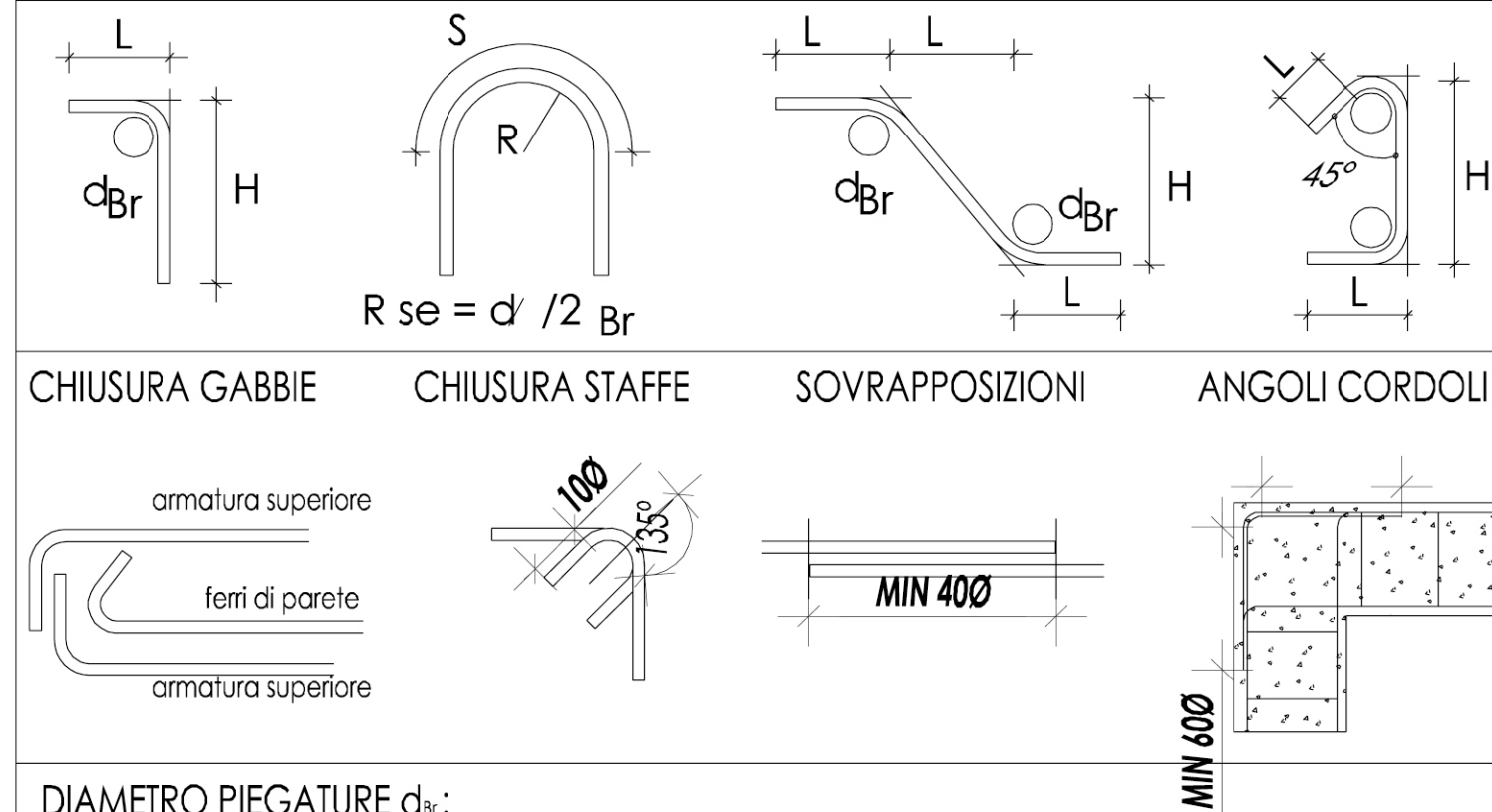

DIAMETRO PIEGATURE d_b :

Ø Barra	<20	d _{B7} 4Ø
Ø Barra	Ø16 - Ø26	d _{B7} 7Ø

NOTE:

TUTTE LE QUOTE E LE MISURE DEVONO ESSERE RILEVATE E VERIFICATE DALL'IMPRESA ESECUTRICE, PRIMA DI PROCEDERE CON LE LAVORAZIONI

MATERIALI:	RESINA STETITA PER INCORPORAZIONE BARRE: CAUCESTRUZZO MACRO E MICROPERLATO DI QUALITÀ: CAUCESTRUZZO FONDAZIONE: CAUCESTRUZZO ELEVAZIONE: ACCIARO PER C.A. TIPO F68-M	CONCRETO (C30/37) (mm) FONDAZIONE: ELEVAZIONE: 10x10x40 10x10x40 3,5 (0-0,5)
	Ø=125 mm h=120 mm Ø=125 mm classe minima di resistenza 14 rapporto $\lambda_{CT} = 0,65$ diametro massimo nell'30mm Ø=125 mm classe minima di resistenza 14 rapporto $\lambda_{CT} = 0,65$ diametro massimo nell'30mm Ø=125 mm rapporto λ_{CT} variabile contenuto in acciainamento variabile	Classe di esposizione ordinaria
ISOLAMENTO:	C.A. 240	ACCIARO TIPO T 220: contenuto in acciainamento, accettabile Ø=125 mm